



LIVING IN THE MIDDLE OF THE CULTURAL HEART OF THE HAGUE

TYPE L2 Turfmarkt-side

- Floors 14 to 16
- Floor space approx. 83.0 m²
- 2 bedrooms
- Outdoor space 4,7 m²

- The corner kitchen is equipped with a Quooker tap, an ATAG dishwasher, combi oven with integrated microwave, 80 cm wide induction hob, stainless steel extractor hood with stainless steel splash screen, fridge with freezer compartment and black composite kitchen worktop.
- Balcony on the north-west of approx. 4.7 m².
- Two bedrooms of approx. 7.9 and 16 m².
- The indoor storage room includes space, drains and water lines for the washing machine and dryer.
- The bathroom has a walk-in shower with hard glass wall and walk-in door, stainless steel shower drain, sink and electric towel radiator. The floor has large light gray tiles; the walls have white wall tiles up to the ceiling.

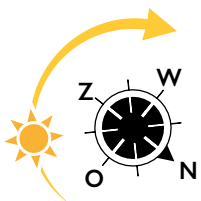



FLOORS 14 TO 16

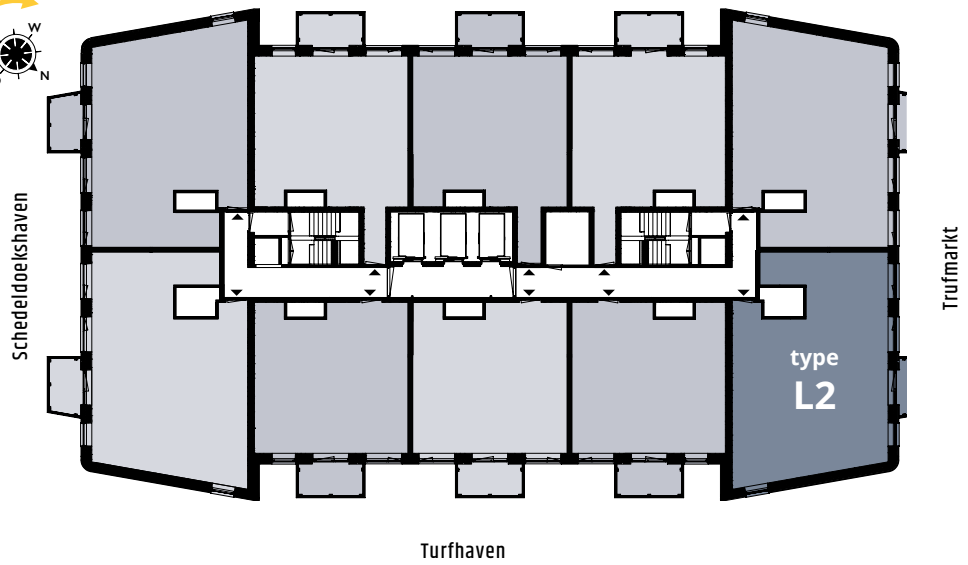

LOCATION

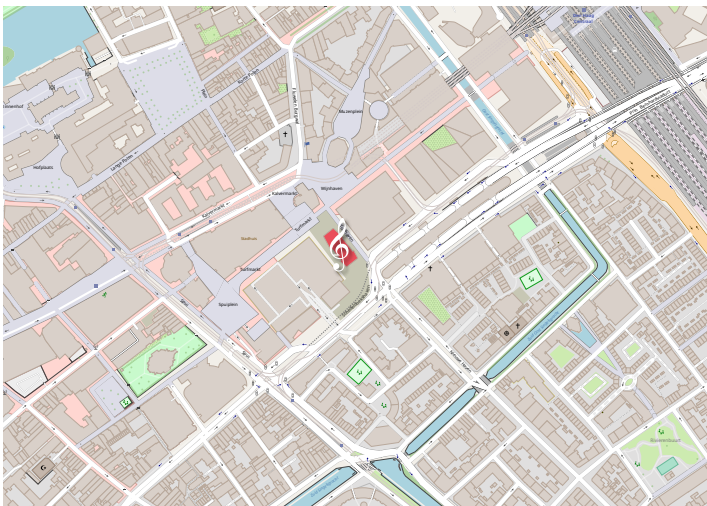

YOU CAN FIND THIS TYPE AT:

- 14th floor | Turfhaven 331
- 15th floor | Turfhaven 351
- 16th floor | Turfhaven 371